

CME Booster

With inlet pressure switch



TM06 3876 1115

Fig. 1 CME Boosters with inlet pressure switch

The compact Grundfos CME Booster is suitable for water supply in domestic applications. The integrated speed controller keeps a constant pressure in the pipe system. The pressure sensor constantly monitors changes in the discharge pressure of the pump and changes the speed of the pump accordingly.

The inlet pressure switch prevents the pump from operating in case of low inlet pressure.

The booster is very easy to install. When the booster has been connected to the pipework, it is all a matter of plugging the plug into a socket, and the system is operational.

The CME Booster consists of these components:

- CME pump with integrated frequency converter
- 5-way fitting with or without non-return valve*)
- diaphragm tank
- pressure gauge
- pressure sensor
- inlet pressure switch mounted on stainless or brass fitting.*)

*) Depending on the model.

Applications

The CME Booster is mainly used for domestic and light commercial water supply or pressure boosting.

Application	CME 1	CME 3	CME 5	CME 10
Single-family houses	●	●	○	○
Two-family houses	○	●	●	●
Cluster houses		●	●	●
Blocks of flats		●	●	●
Schools		●	●	●
Small hotels/guest houses		●	●	●
Small office buildings		●	●	●
Agriculture		○	●	●
Irrigation		○	●	●

- Recommended
- Applicable.

Features

- Constant pressure via integrated speed control
- compact, robust, stainless steel design
- easy installation
- dry-running protection
- low noise
- inlet pressure switch with manual or automatic restart.

Performance range

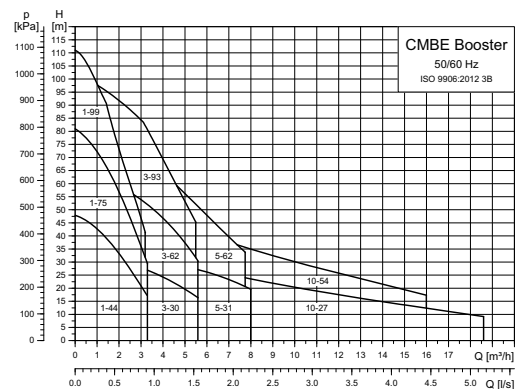

TM06 1039 1414

Selection guide

Example: sizing and selection

Find the right booster

- How many taps? 6.
 - How many floors? 3.
- Result: CMBE 1-75

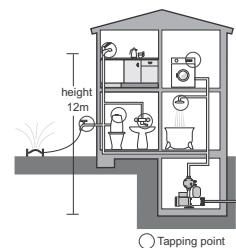

TM05 9319 3713

Number of floors	Number of taps			
	1-5	6-10	11-20	21-50
4	CMBE 1-75	CMBE 1-75	CMBE 3-62	CMBE 3-93
3	CMBE 1-44	CMBE 1-75	CMBE 3-62	CMBE 3-62
2	CMBE 1-44	CMBE 1-44	CMBE 3-62	CMBE 3-62
1	CMBE 1-44	CMBE 1-44	CMBE 3-30	CMBE 3-62

Fig. 2 Selection guide

Preconditions:

- 3 bar tap pressure. If you want 4 bar pressure, move 2 floors up in the table.
- Flooded suction and 0.5 l/s average per tap. Demand factor has been taken into account.

Grundfos cannot be held responsible for wrong sizing based on this guide.

Dimensional drawings

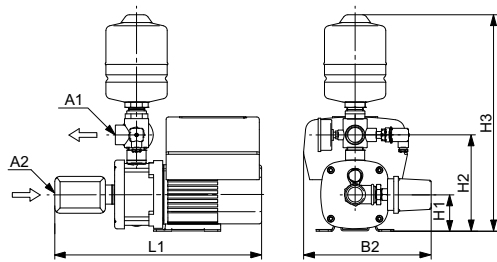

Fig. 3 Dimensions

TM06 3873 1115

With integrated frequency converter and inlet pressure switch

Pump type	H3	H2	H1	L1	B2	A1 [inch]	A2 [inch]
CMBE 1-44	440	196	75	421	260	1	1
CMBE 1-75	440	196	75	457	260	1	1
CMBE 1-99	440	196	75	493	260	1	1
CMBE 3-30	440	196	75	421	260	1	1
CMBE 3-62	441	197	75	440	260	1	1
CMBE 3-93	460	212	90	500	260	1	1
CMBE 5-31	440	196	75	442	286	1	1 1/4
CMBE 5-62	441	197	75	440	260	1	1 1/4
CMBE 10-27	520	258	100	520	290	1 1/2	1 1/2
CMBE 10-54	520	258	100	506	316	1 1/2	1 1/2

With integrated frequency converter and inlet pressure switch (KIWA-ATA approved)

Pump type	H3	H2	H1	L1	B2	A1 [inch]	A2 [inch]
CMBE 1-44	506	198	75	473	293	1	1
CMBE 1-75	506	198	75	507	293	1	1
CMBE 3-30	506	198	75	473	293	1	1
CMBE 3-62	506	198	75	491	293	1	1
CMBE 5-31	506	198	75	494	292	1	1 1/4
CMBE 5-62	506	198	75	491	293	1	1 1/4

Technical data

Pump type	Voltage [V]	I _{max} [A]	P ₁ [W]	Plug type
CMBE 1-44	1 x 200-240	3.45 - 2.9	615	Schuko, US, AU, UK or without plug
CMBE 1-75	1 x 200-240	6.7 - 5.6	998	
CMBE 1-99	1 x 200-240	6.7 - 5.6	1250	
CMBE 3-30	1 x 200-240	6.7 - 5.6	688	
CMBE 3-62	1 x 200-240	6.7 - 5.6	1210	
CMBE 3-93	1 x 200-240	9.1 - 7.6	1720	
CMBE 5-31	1 x 200-240	6.7 - 5.6	1090	
CMBE 5-62	1 x 200-240	9.1 - 7.6	1720	
CMBE 10-27	1 x 200-240	6.7 - 5.6	1240	
CMBE 10-54	1 x 200-240	9.1 - 7.6	1710	

Materials

Component	Material
Terminal box	Composite PC/ASA and silumin (Alu)
Stator housing	Silumin (Alu)
Fan cover	Composite PBT/PC
Pump housing	Stainless steel, EN 1.4301/AISI 304
Shaft and impeller	Stainless steel, EN 1.4301/AISI 304
Flange	Cast iron

Thermal protection

CME Booster pumps require no external motor protection. The MGE motor incorporates thermal protection against slow overloading and blocking (IEC 34.11: TP 211).

Control panel

The control panel on the E-pump terminal box makes it possible to change the setpoint settings manually.

MGE 0.55 to 1.5 kW

The operating condition of the pump is indicated by the Grundfos Eye on the control panel. See fig. 4, pos. A.

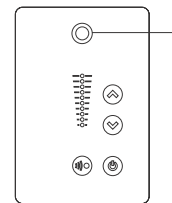
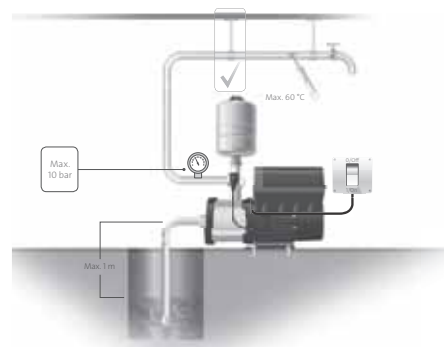

Fig. 4 Control panel on CME pump

Set the desired setpoint by pressing ⊕ or ⊖. The light fields on the control panel will indicate the setpoint set. Continuously pressing ⊖ will stop the pump.

Pressing ⊗ will enable IR communication with the Grundfos GO and with other products of the same type using IR communication.

Installation



TM05 5993 4312

TM063676 0215

© Copyright Grundfos Holding A/S. The name Grundfos, the Grundfos logo, and be think innovate are registered trademarks owned by Grundfos Holding A/S or Grundfos A/S, Denmark. All rights reserved worldwide.

98870703 0315
ECM: 1149152

Subject to alterations.